

**LH 5300**

**INSTALLATION  
INSTRUCTIONS**

# LEVER HANDLE SET INSTALLATION

Note: Thrubolts are provided and recommended

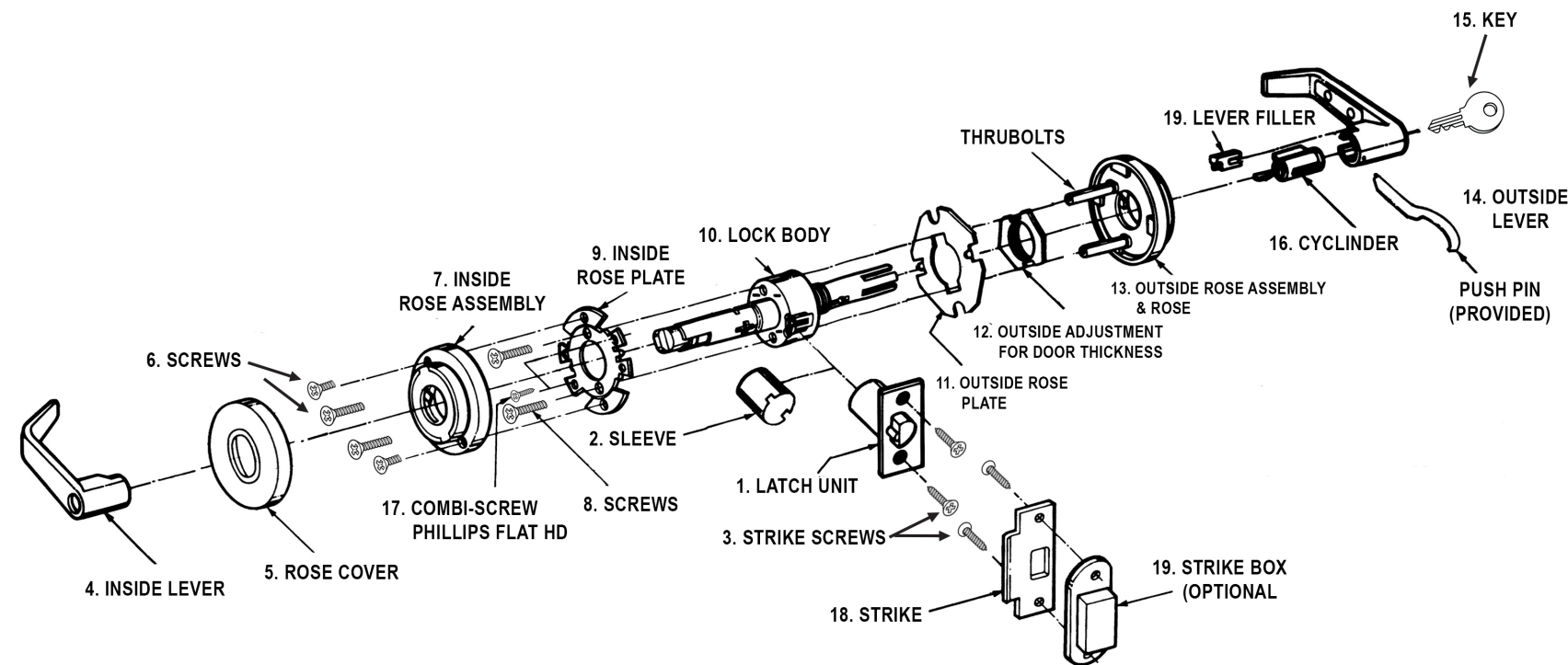

TOOLS REQUIRED
<ul style="list-style-type: none"><li>• PUSH PIN (PROVIDED)</li><li>• NO. 2 PHILLIPS SCREWDRIVER</li><li>• 1/8 INCH DRILL BIT</li><li>• 5/16 INCH DRILL BIT</li></ul>

1.

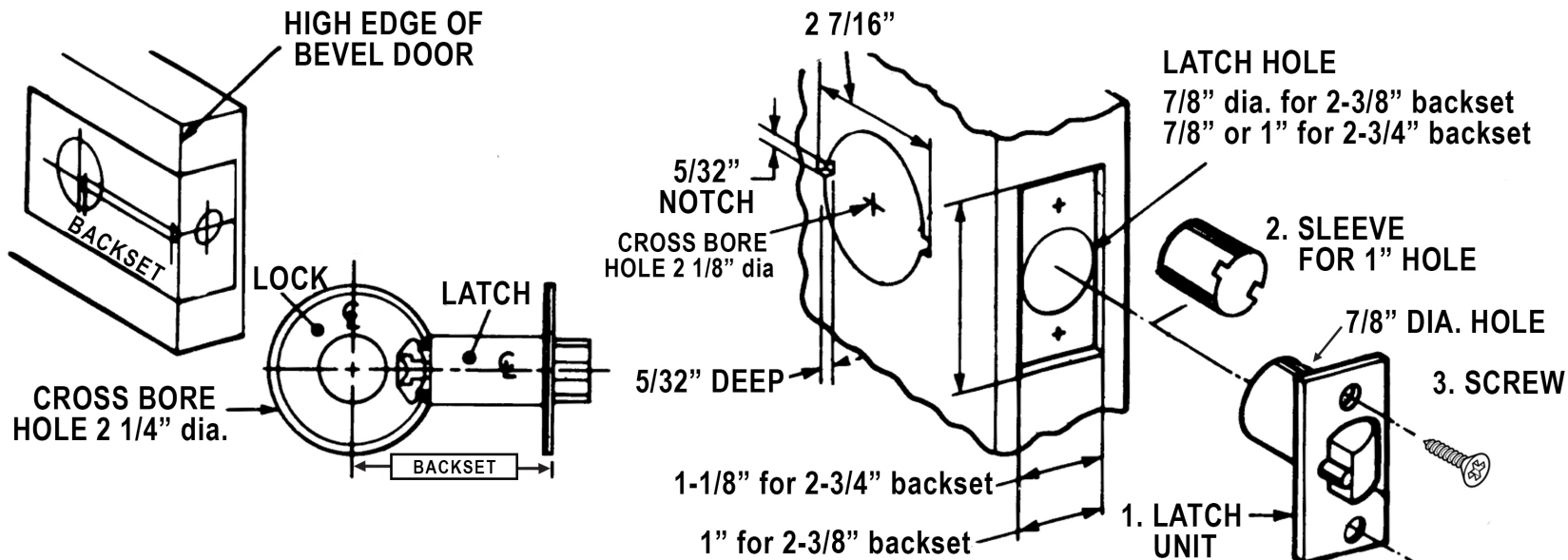

(Figure 1.)

(Figure 2.)

## A. DOOR PREPARATION

1. Check lock for proper backset and boy outside.
2. Place paper template (supplied) on door and mark for holes. Drill the cross-bore hole and then the latch hole.
3. Mortise latch unit 5/32" into door edge to dimensions shown in figure 2.
4. Insert latch unit (1) with sleeve (2) if hole is 1" dia. or without sleeve into 7/8 dia. hole.
5. Drill two 9/64" dia. holes and secure latch unit with screws supplied.

2.

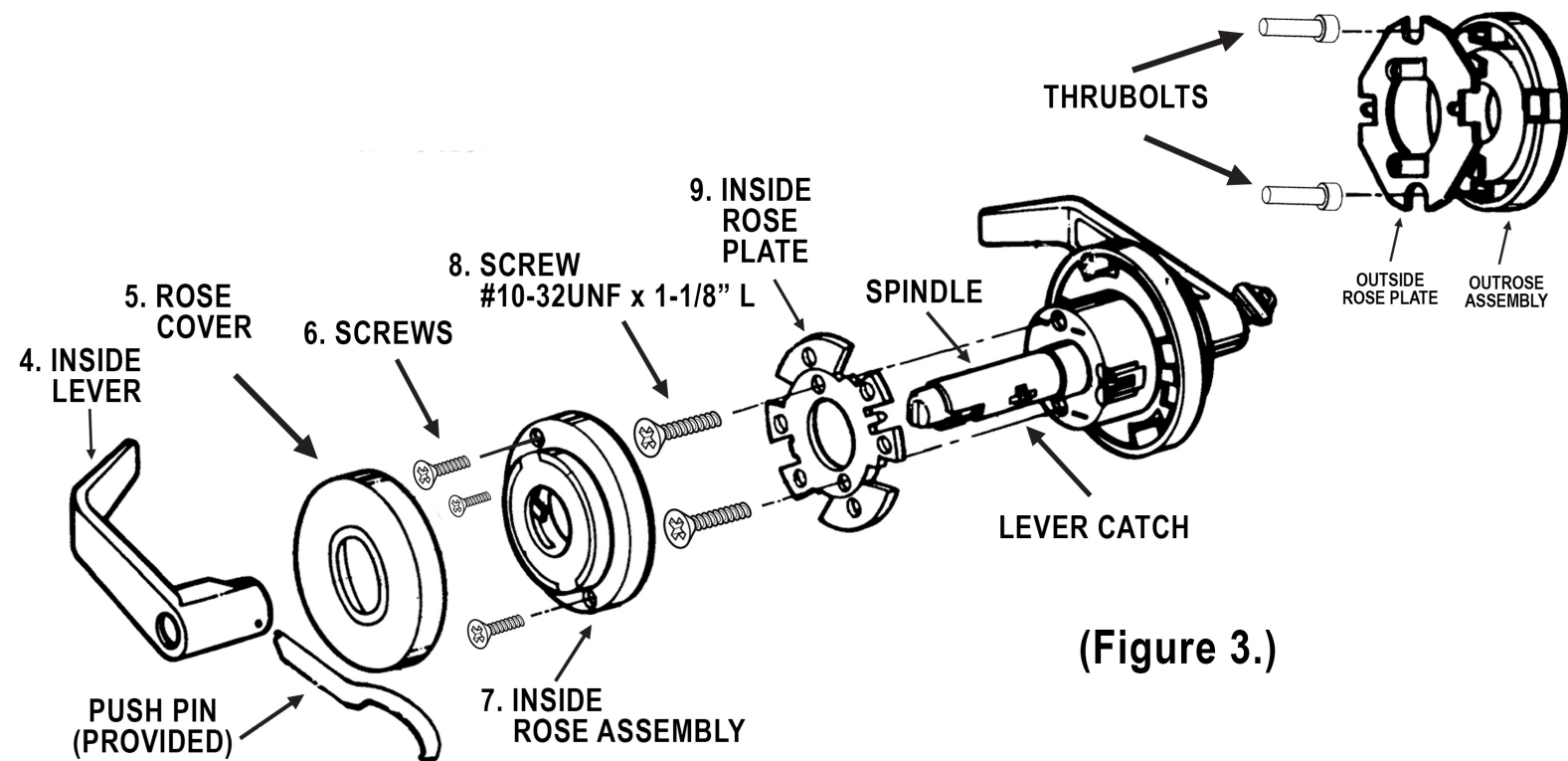

(Figure 3.)

#### B-1. DISASSEMBLY OF LOCKSET UNIT (INSIDE)

1. To remove inside lever (4), insert push pin (provided) into hole on lever to depress the lever catch. Slide the lever from the tube. Remove rose cover (5) by slightly twisting counter-clockwise and pulling off.
2. Unscrew two screws and remove inside rose assembly (7).
3. Unscrew two #10-32UNF x 1 1/8" L (8) screws and remove inside rose plate (9).

#### B-2. INSTALL THRUBOLTS

MAKE SURE INSTALL THRUBOLTS BEFORE LOCK INSTALLATION

1. Disassemble inside lever and rose assembly, rose plate.
2. Make clearance between outside rose plate and outside rose assembly and insert the thrubolts (provided 2pcs additionally) into the cavities for thrubolts in the rose assembly.
3. Continue lock installation per instructions. Replace outside rose plate.

3.

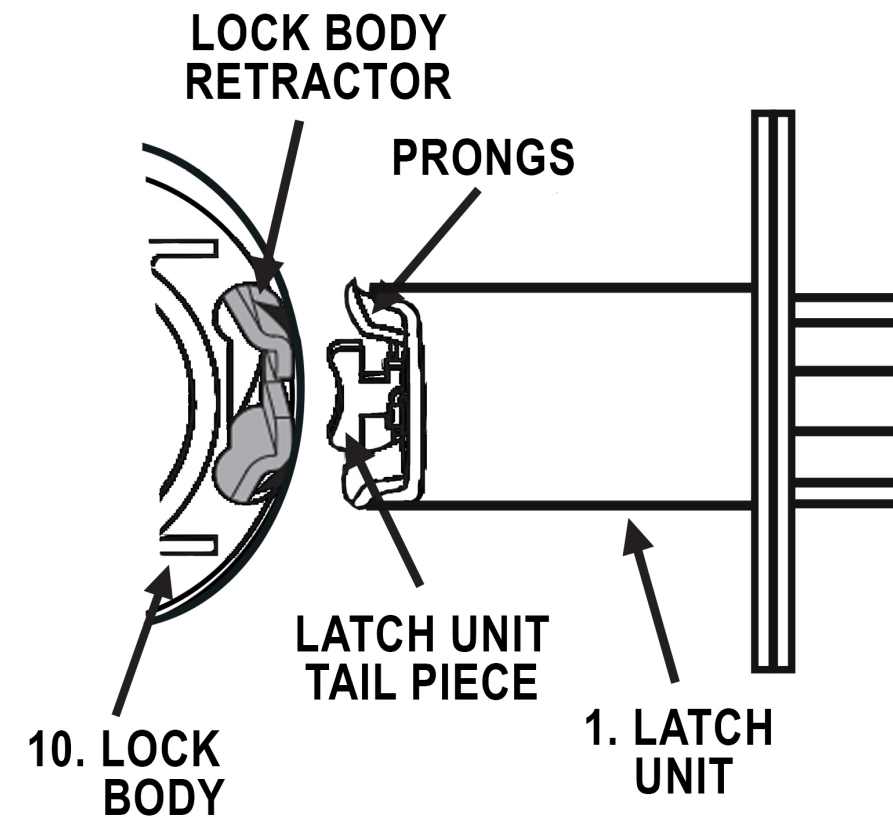

#### C. LOCK BODY ALIGNMENT & CENTERING

The lock body must engage the latch unit (1) prongs as shown. The lock body retractor must engage the latch unit tail piece. Door must be opened when installing lockset.

4.

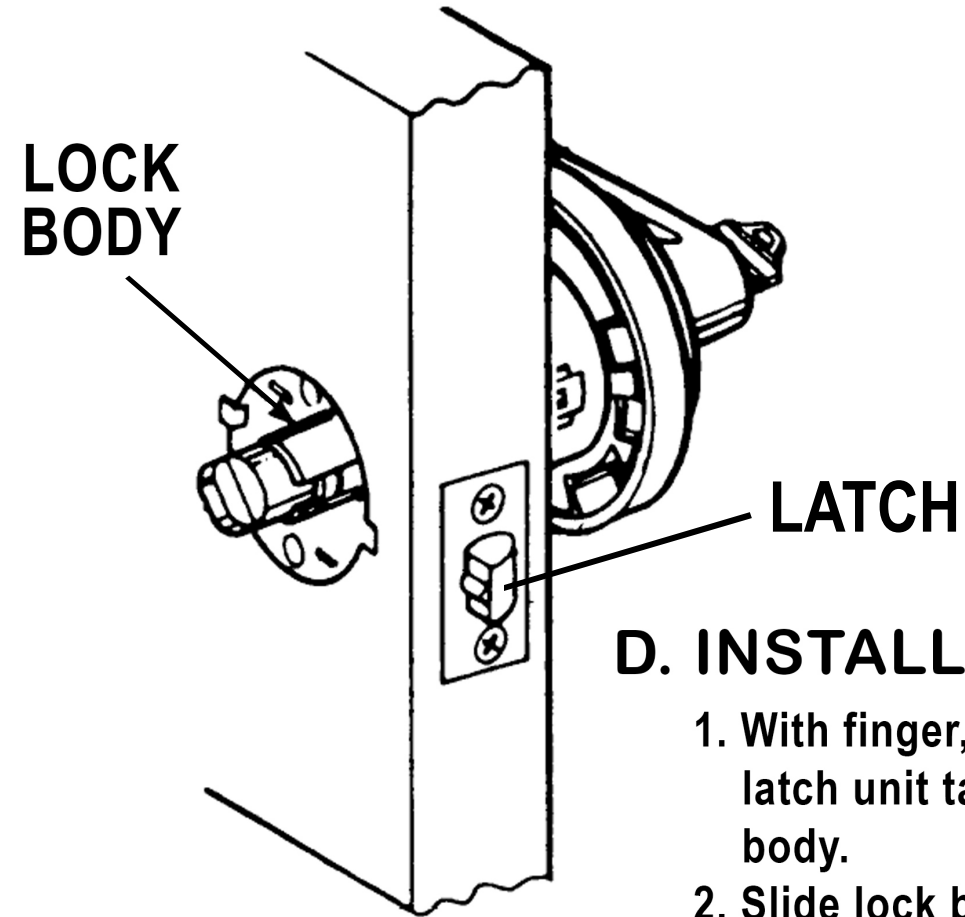

#### D. INSTALLATION OF LOCK UNIT

1. With finger, depress the latch, extending the latch unit tail piece to aid engaging the lock body.
2. Slide lock body into cross-bore hole from exterior of the door.

(Figure 5.)

5.

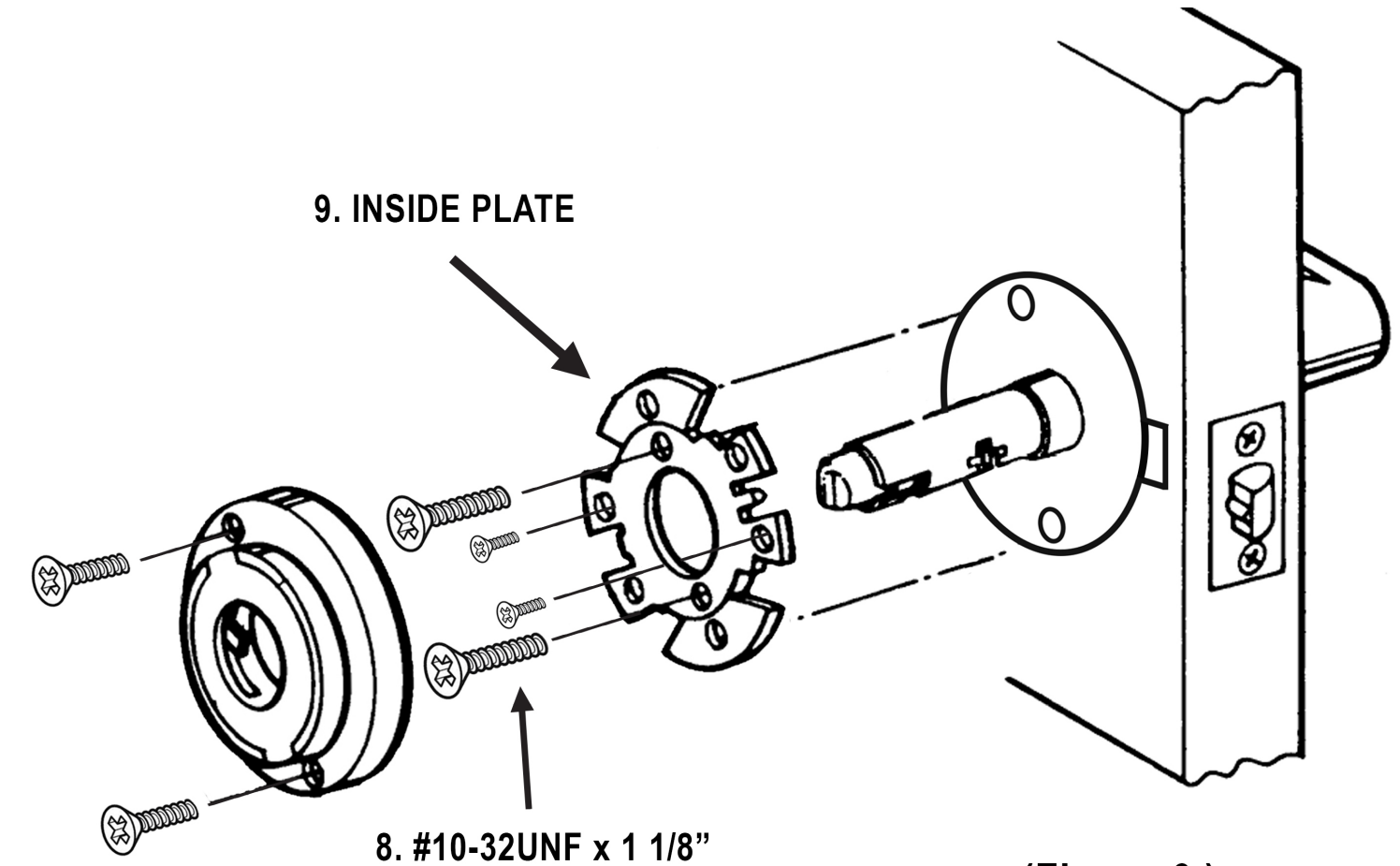

(Figure 6.)

E. Secure the inside rose plate (9) with two screws (8).



6.

## F. ATTACHING INSIDE ROSE

1. Position the inside rose.
2. Secure inside rose.

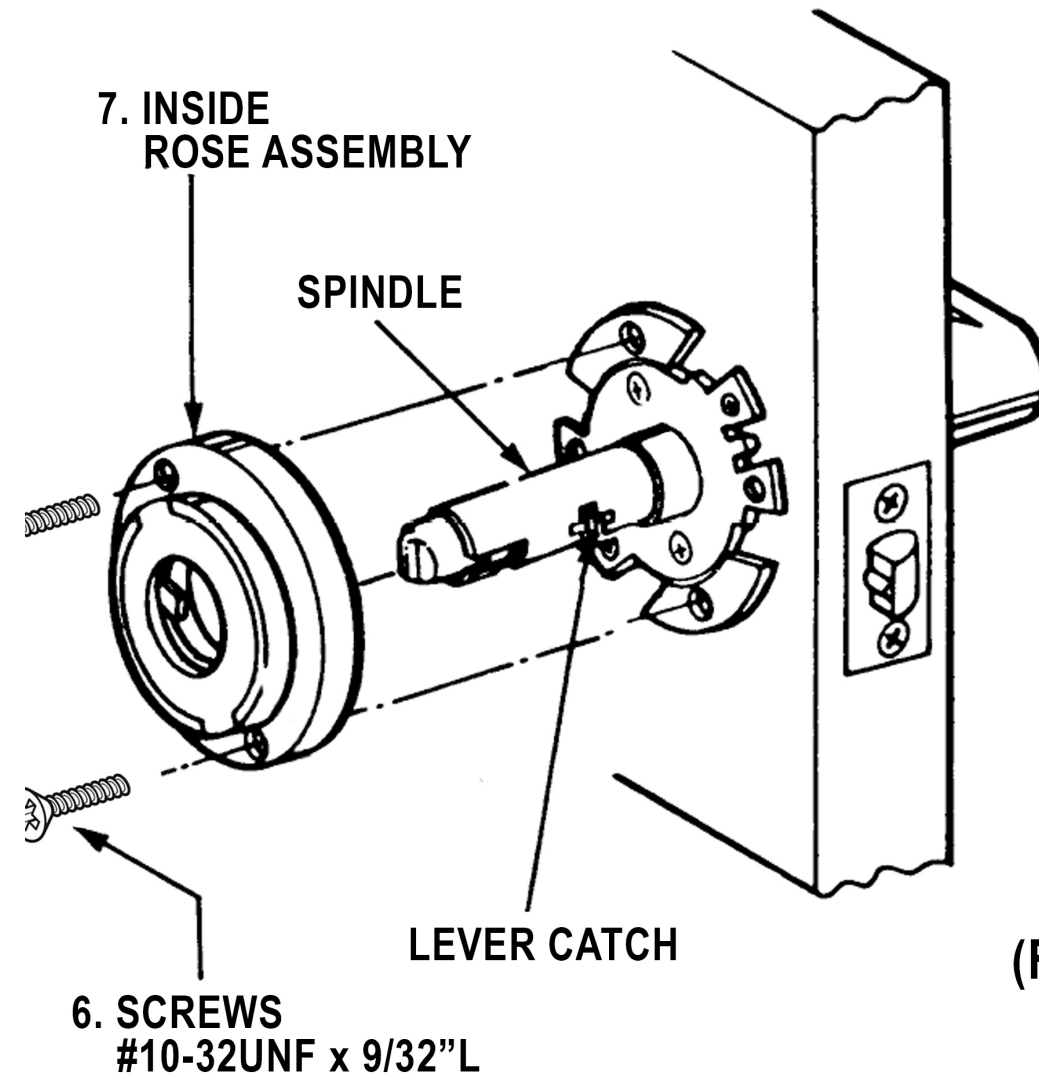

(Figure 8.)

7.

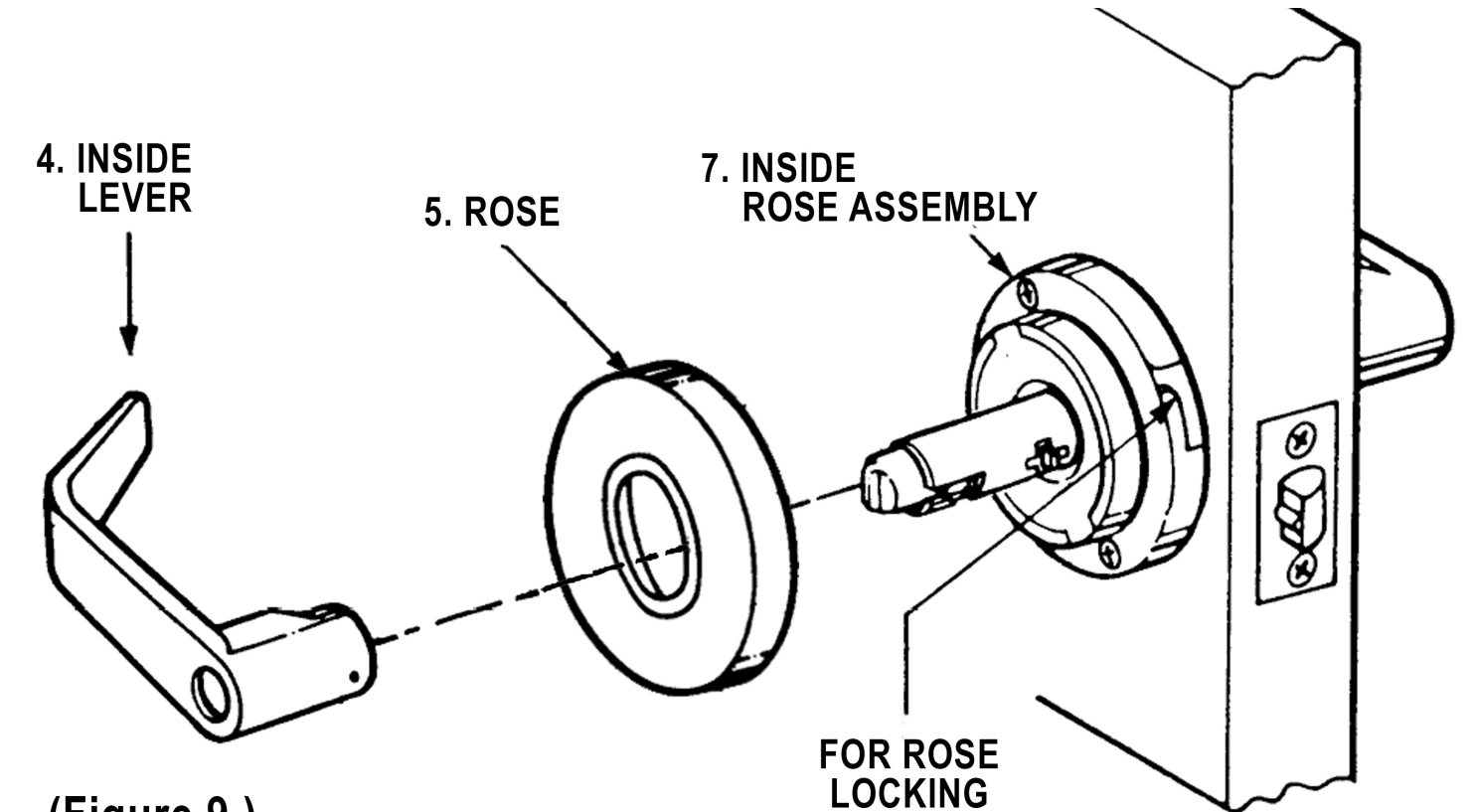

(Figure 9.)

## G. INSIDE LEVER INSTALLATION

1. Place rose cover (5) onto inside rose assembly aligning two notches with recesses in rose and turn clockwise to lock.
2. Slide inside lever (4) onto tube. Make certain lever catch is engaged with lever.

8.

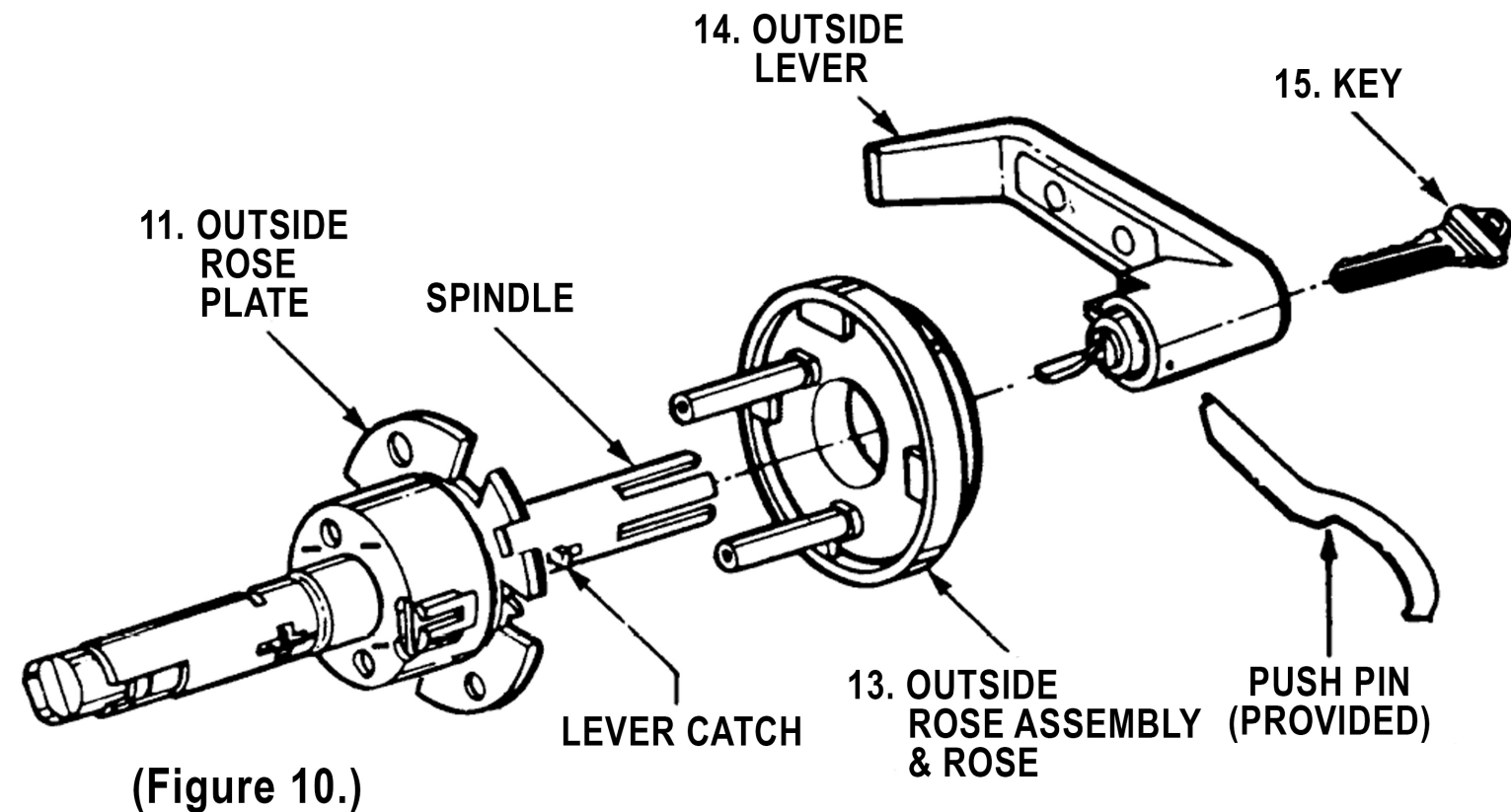

## H. TO REMOVE OUTSIDE LEVER & ROSE

1. To remove outside lever (14) insert key (15) and turn 45° clockwise. Insert push pin into hole on lever to depress lever catch. slide the lever (14) from spindle.
2. Remove outside rose assembly & rose.

9.

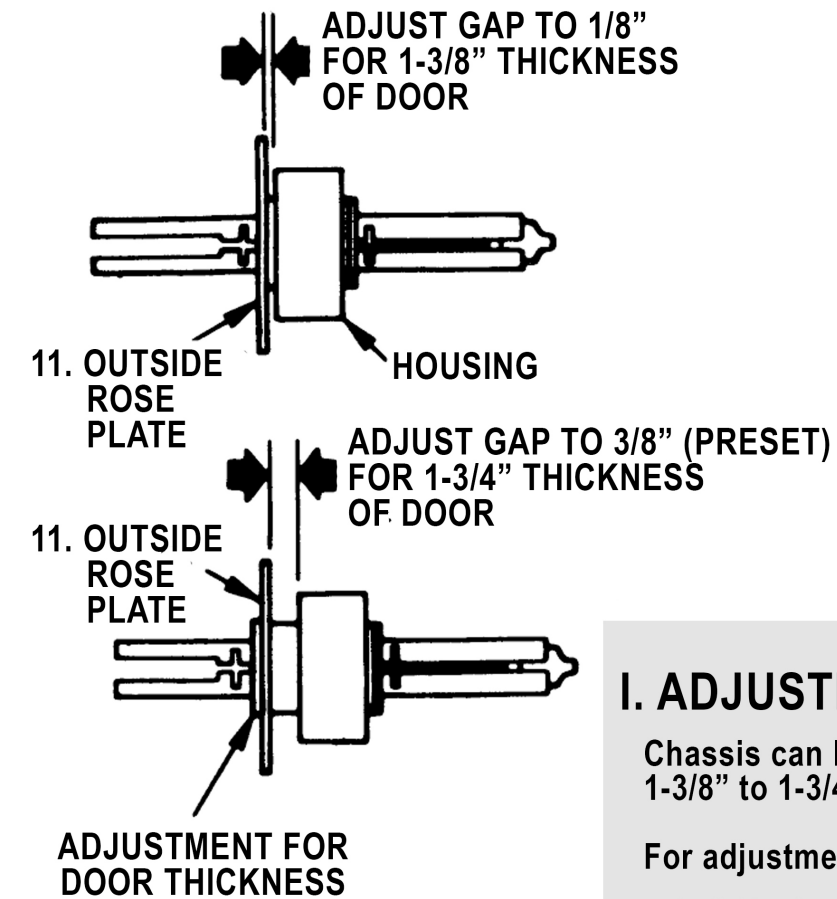

**LEVERSET IS PRESET FOR 1 3/4" DOORS**

## I. ADJUSTMENT FOR DOOR THICKNESS

Chassis can be adjusted for door thickness range from 1-3/8" to 1-3/4".

For adjustment of door thickness, see step 8 then:

1. Adjust outside rose plate.
2. Slide outside rose assembly with rose cover (13) onto spindle.

(Figure 11.)

## J. INSTALLING STRIKE

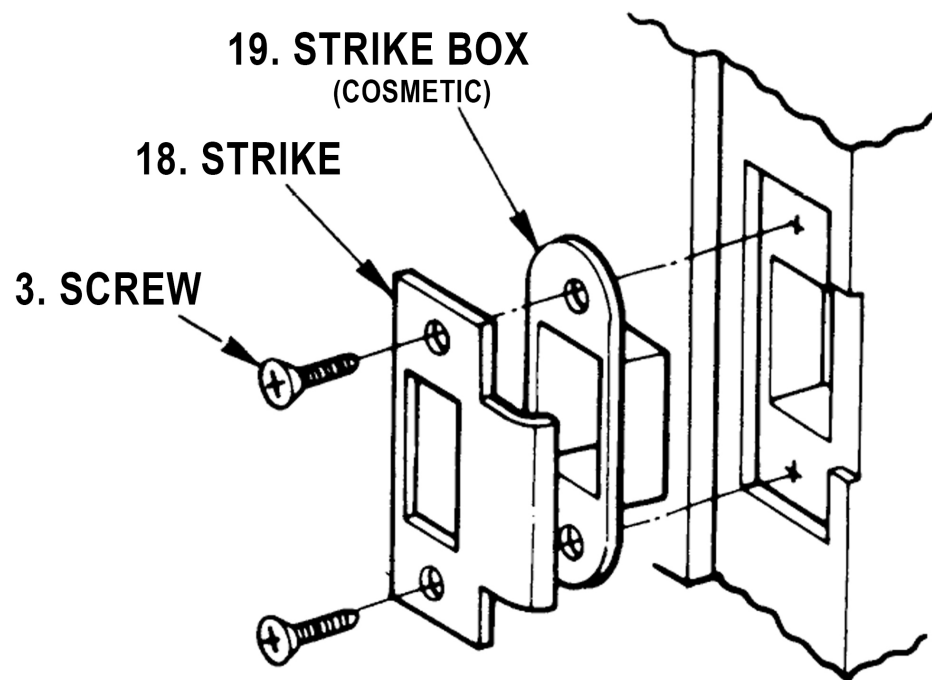

(Figure 12.)

If you have any questions regarding  
installation, contact us at  
1.888.737.6515, email us at [info@](mailto:info@LawrenceHardwareOnline.com)  
[LawrenceHardwareOnline.com](http://LawrenceHardwareOnline.com)  
or visit us online at  
[LawrenceHardwareOnline.com](http://LawrenceHardwareOnline.com)